

# MADDE<sup>⊕</sup>

## HAWTHORN

Hawthorn Coat Rack

Hawthorn, porte-manteaux

Appendiabiti Hawthorn

Hawthorn kapistok

Hawthorn Garderobenständer

---



**GB** Recommendations for the continual safe use of this product are stated on the final page of these instructions. Please retain for future reference.

**FR** Les conseils d'utilisation de ce produit sont indiqués sur la dernière page de ces instructions. Veuillez les conserver pour vous y référer si besoin.

**IT** I consigli per un continuo uso sicuro del prodotto sono indicati nella pagina finale delle istruzioni. Si prega di conservarle per riferimenti futuri.

**NL** Aanwijzingen voor veilig gebruik van dit meubel worden toegelicht op de laatste pagina van deze instructies. Bewaar deze folder goed.

**DE** Auf der letzten Seite dieser Anleitung findest du Hinweise für eine langfristige sichere Anwendung dieses Produktes. Bitte bewahre sie gut auf.

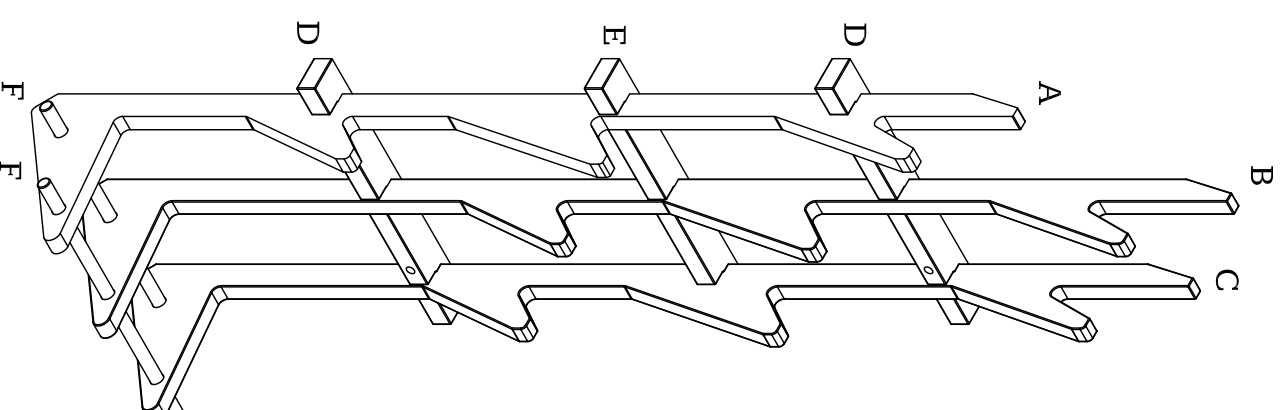

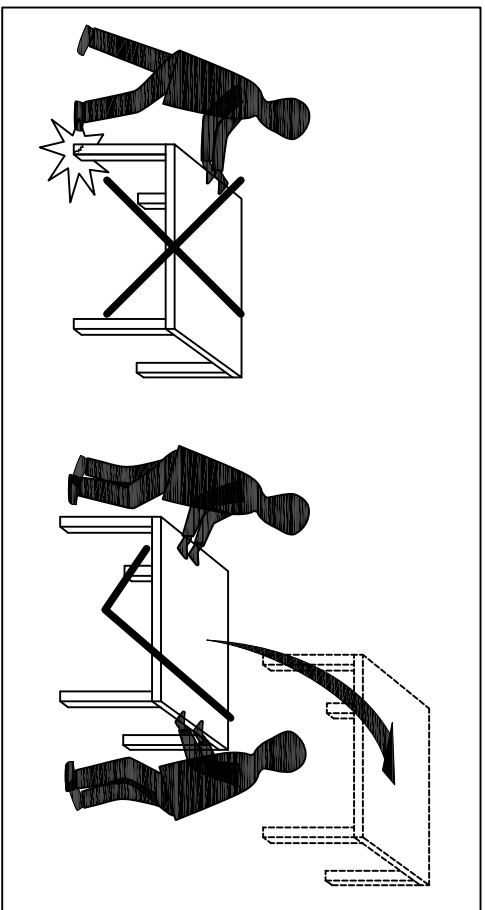
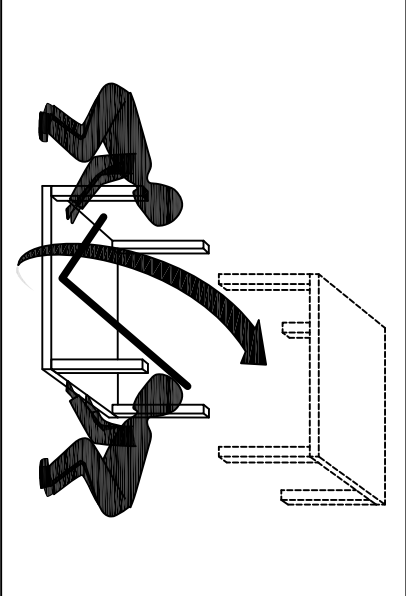
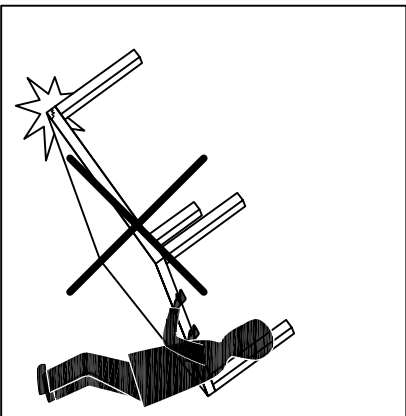
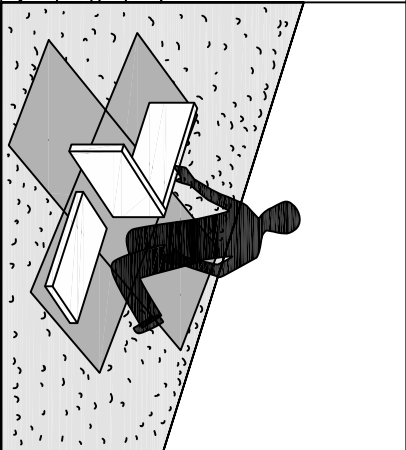
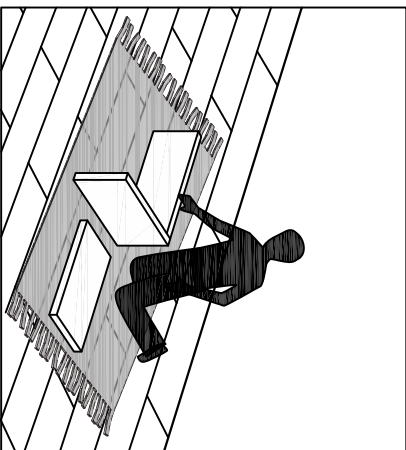
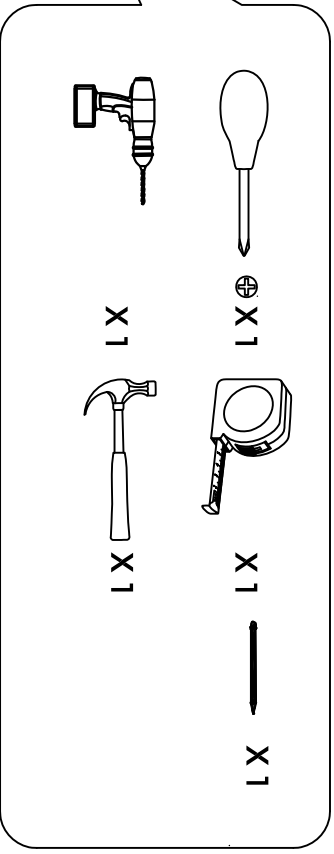
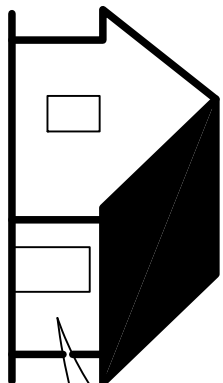
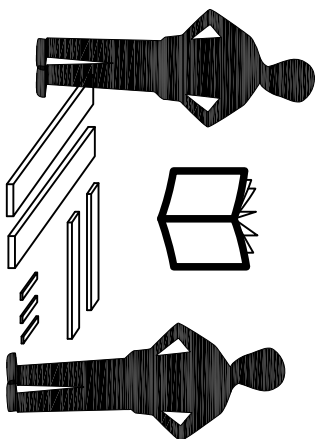

H1 X 9  
 (M3.5 X 35)

H2 X 4  
 (M3.5 X 45)

H3 X 4



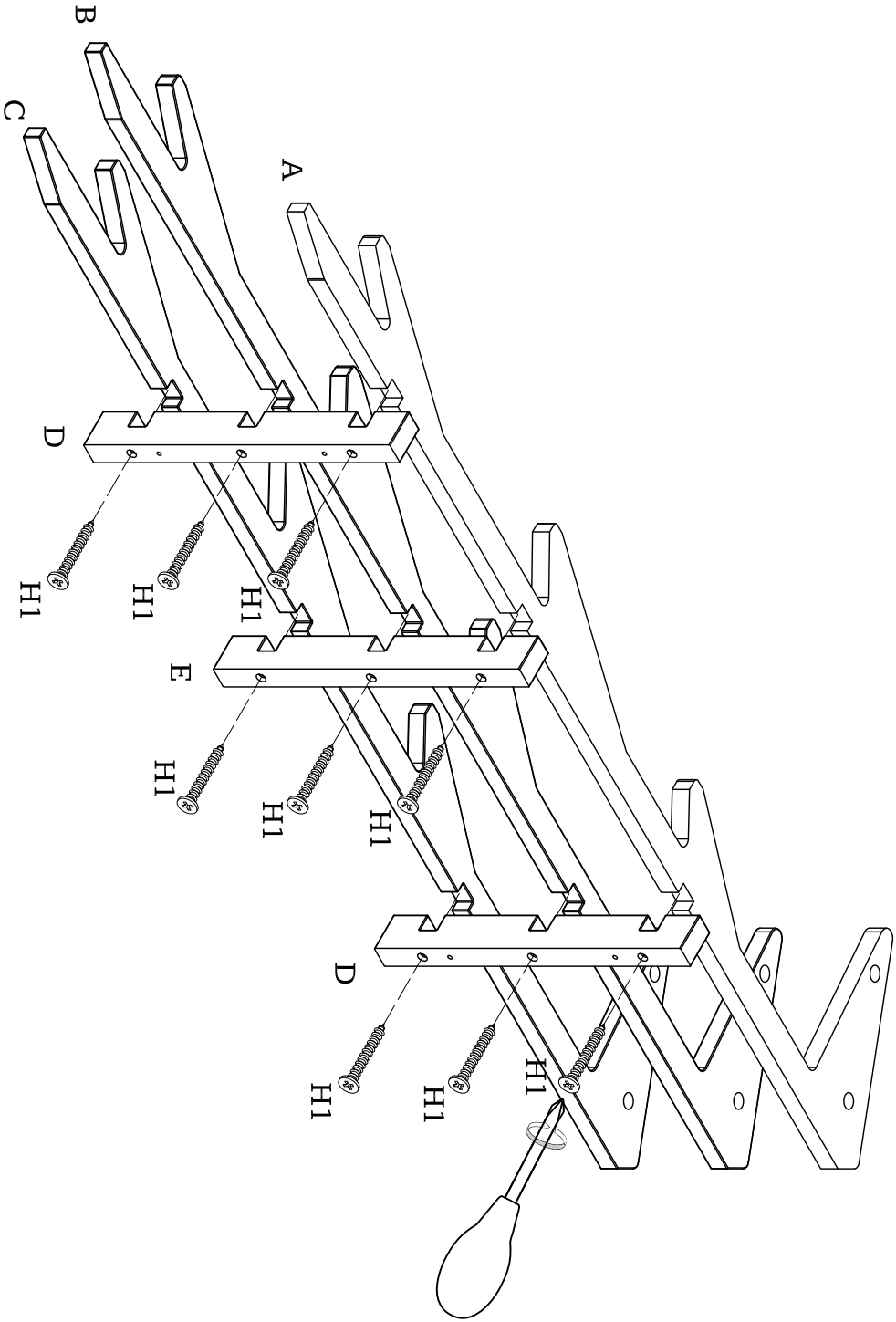

# 2

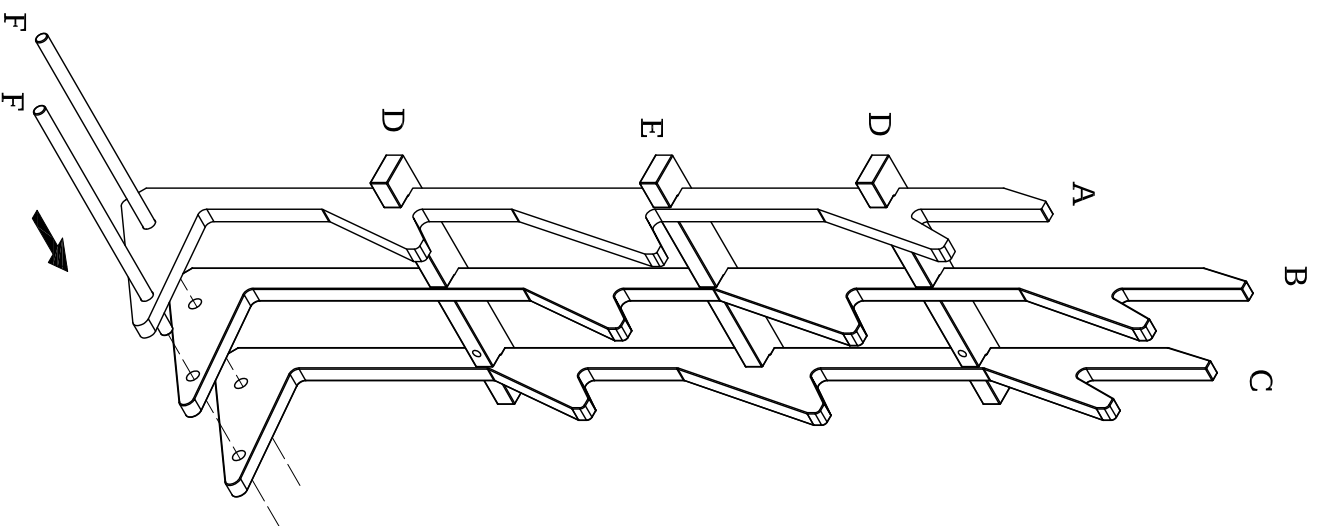

# 3

